



Town of Manchester

41 Center Street • P.O. Box 191
Manchester, Connecticut 06045-0191
www.manchesterct.gov

JAY MORAN, MAYOR
MARGARET H. HACKETT, DEPUTY MAYOR
STEVE GATES, SECRETARY

DIRECTORS
YOLANDA CASTILLO
MICHAEL H. CONNOLLY
CHERI A. ECKBRETH
PAMELA FLOYD-CRANFORD
MATTHEW S. GALLIGAN
SARAH L. JONES

SCOTT SHANLEY, GENERAL MANAGER

June 11, 2019

Central Region WUCC
c/o Mr. Brendan Avery
Hazardville Water Company
281 Hazard Avenue
Enfield, CT 06082

RE: Metropolitan District/Manchester Water Department ESA – Bell St., Glastonbury CT

Dear Mr. Avery,

The Metropolitan District (MDC) and the Manchester Water Department (MWD) would like a revision to their Exclusive Service Areas (ESA) on Bell Street in the Town of Glastonbury. This modification is the result of a request from a developer of a parcel which both utilities had a part of in their ESA. Since the MWD was much further away from the property and was cost prohibitive to extend a water main to serve the parcel, it was determined that MDC could service the entire parcel.

Attached is a map prepared by MDC which shows the parcel being developed and delineates the proposed ESA change requested by the MDC and MWD. Please do not hesitate to contact me if you have any questions at 860-647-3115. Thank you.

Sincerely,

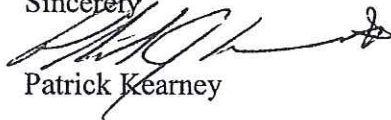

Patrick Kearney

C: Mr. David Banker, P.E. MDC



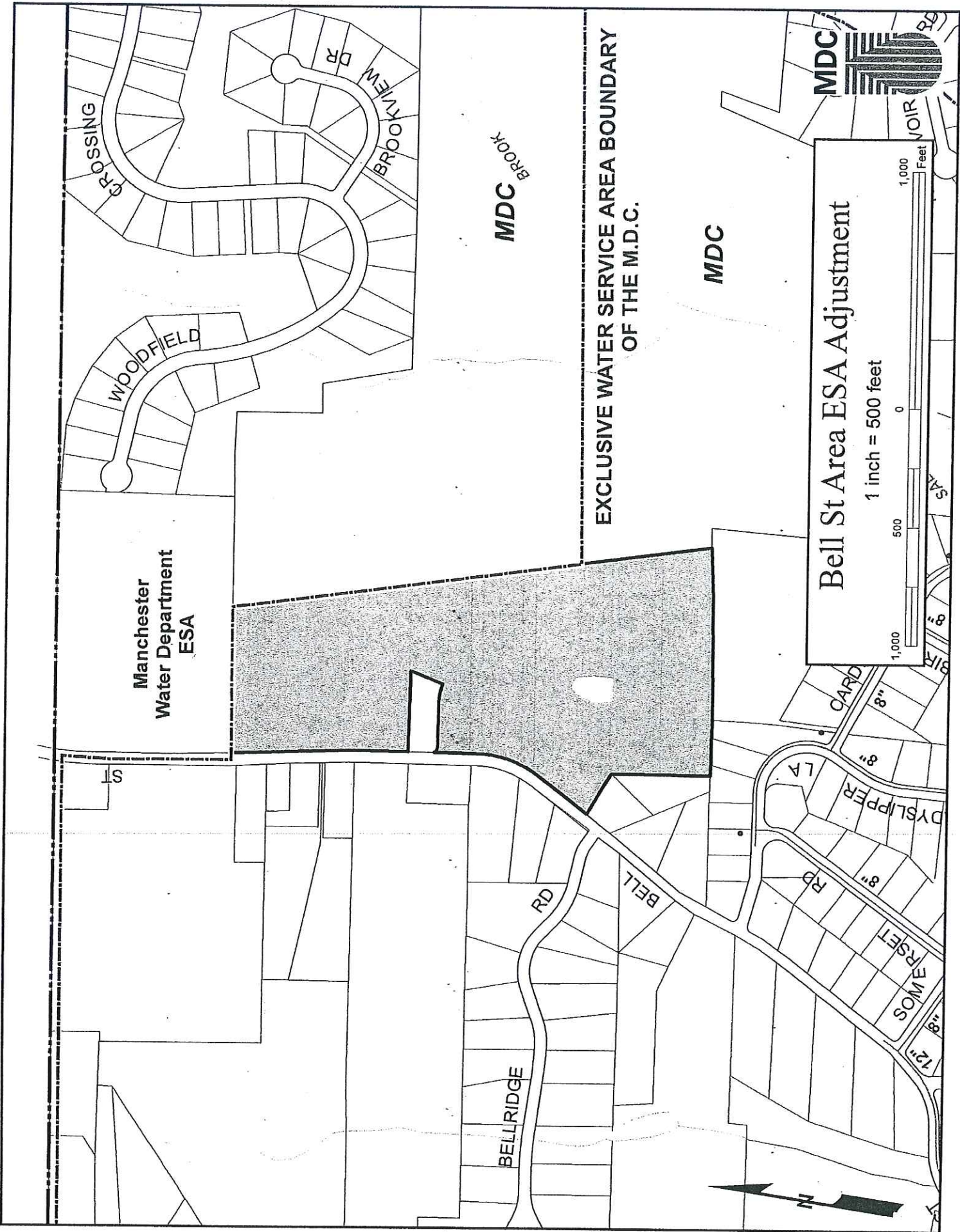

Manchester
Water Department
ESA

BROOK
MDC

EXCLUSIVE WATER SERVICE AREA BOUNDARY
OF THE M.D.C.

MDC

Bell St Area ESA Adjustment

1 inch = 500 feet

